

3D PDF DATASHEET

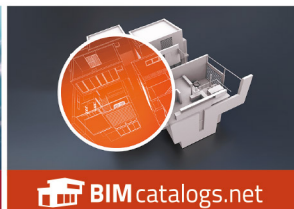

 **eCATALOG**solutions



 **BIM** catalogs.net



 **PART**solutions



Create Your Individual 3D PDF
Datasheet



Learn How to Create Your
Mechanical Product Catalog



Learn How to Create Your BIM
Product Catalog



Reduce Your Costs in
Engineering and Purchasing



TEN26-1040-CEN26-92

ROLLON
BY TIMKEN

3D View

To activate the interactive 3D view, you must trust this document (see hint on the top) in Adobe Acrobat and click on the question mark.



Zoom

Moves you toward or away from objects in the scene when you drag vertically. You can also zoom with the hand tool by holding down Shift as you drag.



Pan

Moves the model vertically and horizontally only. You can also pan with the hand tool: Ctrl-drag.



Rotate

Turns 3D objects around relative to the screen. How the objects move depends on the starting view, where you start dragging and the direction in which you drag.

3D PDF DATASHEET



 **eCATALOG**solutions



 **BIM** catalogs.net



 **PART**solutions



Create Your Individual 3D PDF
Datasheet



Learn How to Create Your
Mechanical Product Catalog



Learn How to Create Your BIM
Product Catalog



Reduce Your Costs in
Engineering and Purchasing



TEN26-1040-CEN26-92

ROLLON
BY TIMKEN

2D derivation

ISO View

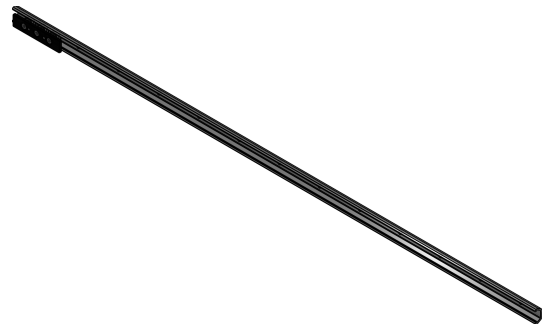

3D PDF DATASHEET



eCATALOGsolutions



BIM catalogs.net



PARTsolutions



Create Your Individual 3D PDF Datasheet



Learn How to Create Your Mechanical Product Catalog



Learn How to Create Your BIM Product Catalog



Reduce Your Costs in Engineering and Purchasing



TEN26-1040-CEN26-92

ROLLON
BY TIMKEN

Technical drawings

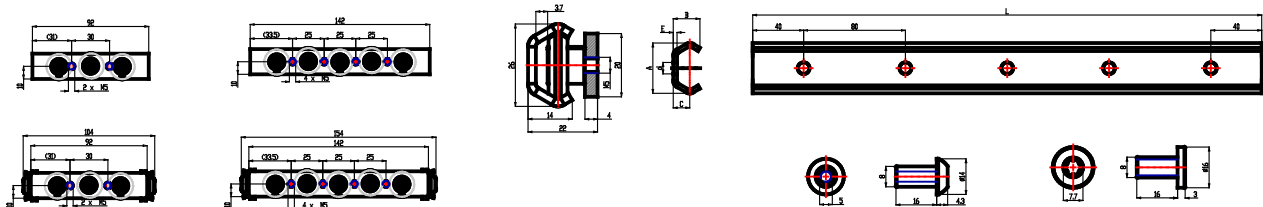

3D PDF DATASHEET

Create Your Individual 3D PDF
Datasheet ▶



 **eCATALOG**solutions

Learn How to Create Your
Mechanical Product Catalog ▶



 **BIM** catalogs.net

Learn How to Create Your BIM
Product Catalog ▶



 **PART**solutions

Reduce Your Costs in
Engineering and Purchasing ▶



TEN26-1040-CEN26-92

ROLLON
BY TIMKEN

Technical Data

| | |
|-----------------------|----------|
| CODE () | TEN26 |
| L (Rail length / mm) | 1040 |
| SLDR1 (Slider type 1) | CEN26-92 |
| SLDR2 (Slider type 2) | - |
| SLDR3 (Slider type 1) | - |

3D PDF DATASHEET

Create Your Individual 3D PDF
Datasheet



 **eCATALOG**solutions

Learn How to Create Your
Mechanical Product Catalog



 **BIM** catalogs.net

Learn How to Create Your BIM
Product Catalog



 **PART**solutions

Reduce Your Costs in
Engineering and Purchasing



TEN26-1040-CEN26-92

ROLLON
BY TIMKEN

Bill of Materials

| N° | Description | Amount |
|----|---------------------|--------|
| 1 | TEN26-1040-CEN26-92 | 1 |